

**PIERING NOTE**  
PIERS TO BE FOUNDED APPROX. 1200 INTO EXISTING FOUNDATIONS

**NOTE:**  
RAINWATER TANK & AIR CONDITIONING SLABS ARE NOT SHOWN ON SLAB PLAN. REFER TO ARCHITECTURAL DRAWINGS FOR LOCATION AND SIZE. REFER TO STRUCTURAL DETAILS ON SHEET S7 & S8.

\*\* APPROXIMATELY DIMENSION REFER TO ARCHITECTURAL DRAWINGS

APPROXIMATE SEWER TANK LOCATION  
DEPTH TO INVERT 2150

LINE OF INFLUENCE AT GROUND TO SEWER. 1:1 FROM EDGE OF SEWER. TANK TYPICAL

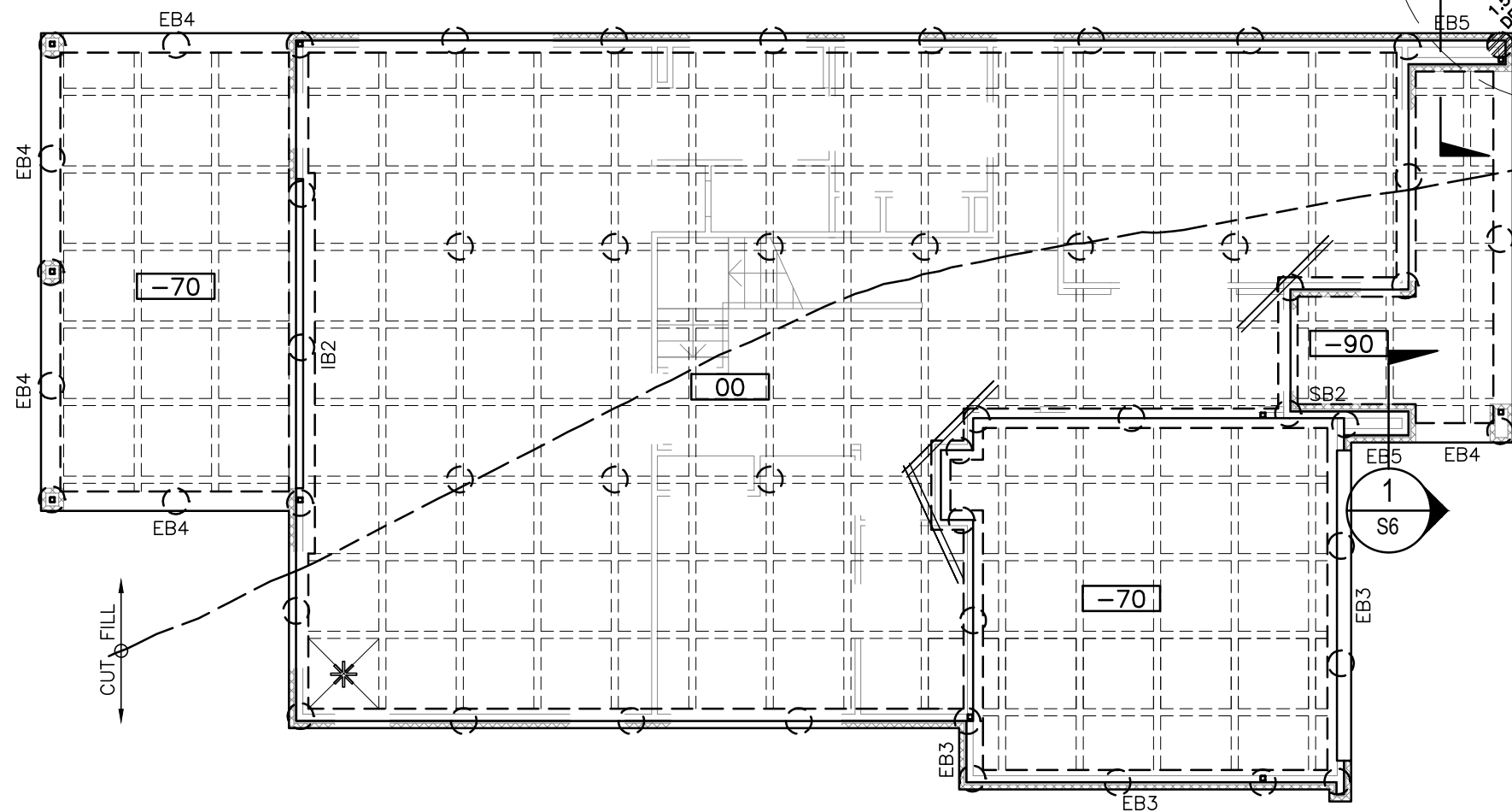

CUT  
FILL

2N12-2000 LONG AT RE-ENTRANT CORNERS

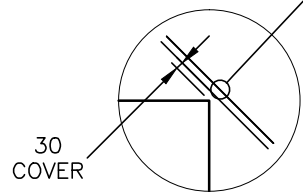

TYPICAL RE-ENTRANT CORNER

**GROUND FLOOR SLAB PLAN**

ALL EDGE BEAMS TO BE 'EB1'  
AND ALL STEP BEAMS TO BE 'IB1'  
UNLESS NOTED OTHERWISE

SLAB SPECIFICATIONS:	
SLAB THICKNESS (mm) :	85
RESIDENCE POD DEPTH (mm) :	300
GARAGE POD DEPTH (mm) :	225
PATIO POD DEPTH (mm) :	225
ALFRESCO POD DEPTH (mm) :	225
RESIDENCE MESH : (TOP COVER: 20mm)	SL82
GARAGE/PORCH & ALFRESCO MESH : (TOP COVER: 30mm)	SL92
TYP. EDGE BEAM REBATE (mm) :	HEBEL B/V 90 160
GARAGE EDGE BEAM REBATE (mm) :	20 86
RESIDENCE SLAB CONCRETE STRENGTH (F'c) :	20 MPa
GARAGE/PORCH & ALFRESCO SLAB CONCRETE STRENGTH (F'c) :	20 MPa
SLAB CONCRETE SLUMP (mm) :	100 mm
PIERS CONCRETE STRENGTH (F'c) :	20 MPa
SITE CLASSIFICATION :	P

**LEGEND**

MARK	NOTE
	1090x1090mm STANDARD POD
	START POD LOCATION
	2N12 or 2/1.5 RW 10.65 TRIMMERS UNDERSIDE OF MESH
	110mm WIDE INTERNAL RIB
	400mm DIA CONCRETE PIER - REFER TO 'BORED PIER NOTES' ON SHEET S1
	400mm DIA PIER FOUNDED BELOW SEWER TANK Z.O.I. <u>DEPTH OF PIERS ON PLAN ARE FROM NATURAL GROUND LEVEL. ADD FILL DEPTH TO PIER DEPTHS NOTED ON PLAN.</u> DEEPER PIERS DEPTHS FOR BEARING MAY BE REQUIRED. REFER TO TYPICAL SECTION.

**NOTES:**

1. THIS DRAWING IS TO BE READ IN CONJUNCTION WITH THE STRUCTURAL NOTES SHEET AND THE SUBSEQUENT DETAIL SHEETS.
2. VERTICAL HEBEL CONTROL JOINTS MUST BE PROVIDED IN ACCORDANCE WITH MANUFACTURER'S RECOMMENDATIONS.
3. UNLESS NOTED OTHERWISE, SERVICES IN EASEMENT(S) ADJACENT TO THIS PROPERTY HAVE NOT BEEN ASSESSED. EVALUATION OF THE EFFECTS OF ANY SERVICES WILL BE MADE FOLLOWING RECEIPT OF FURTHER INFORMATION. THIS INFORMATION WILL BE DOCUMENTED AS AN AMENDMENT TO THESE DRAWINGS IF REQUIRED.
4. IT IS THE RESPONSIBILITY OF THE BUILDER / SUB-CONTRACTOR TO ENSURE CORRECT PIER SETOUT.
5. FOR SITE CLASSIFICATION H1, H2, E & P, ALL PLUMBING SHALL BE DETAILED TO ALLOW FOR MOVEMENT IN ACCORDANCE WITH CLAUSE 5.6.4 OF AS2870.

**SITE CLASSIFICATION NOTE**

THE SITE HAS BEEN CLASSIFIED "H1" PURSUANT TO GEOTECHNICAL REPORT PREPARED BY [REDACTED] REPORT NUMBER [REDACTED] DATED [REDACTED]. THESE DOCUMENTS HAVE BEEN PREPARED IN ACCORDANCE WITH THE PROVISIONS OF AS2870: "RESIDENTIAL SLABS AND FOOTINGS - CONSTRUCTION" CODE ON THE BASIS OF A CLASSIFICATION "P". REFER TO SHEET 1 FOR ADDITIONAL NOTES.

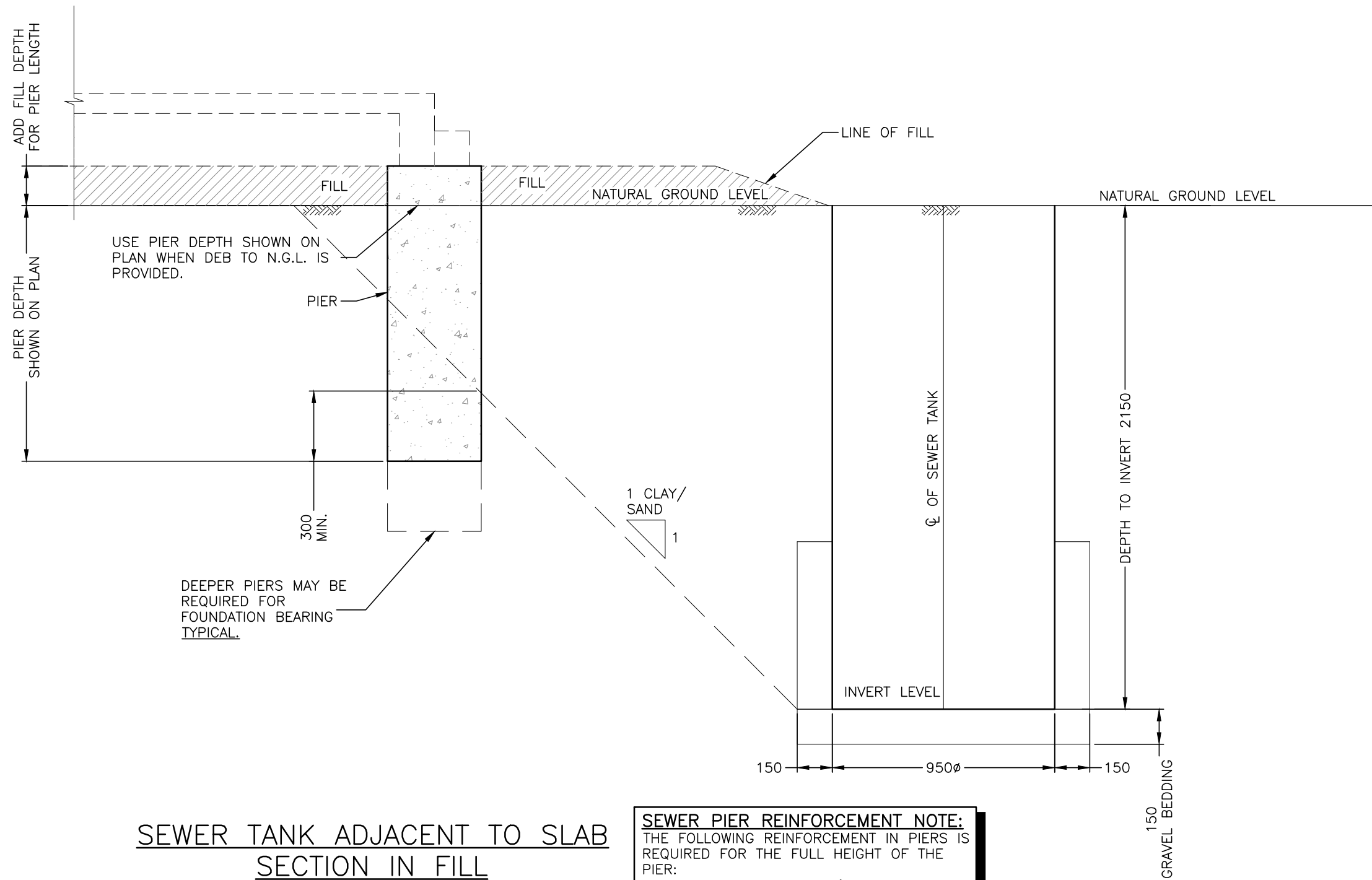

SEWER TANK ADJACENT TO SLAB  
SECTION IN FILL

**SEWER PIER REINFORCEMENT NOTE:**  
THE FOLLOWING REINFORCEMENT IN PIERS IS REQUIRED FOR THE FULL HEIGHT OF THE PIER:

- 2.5m < PIER DEPTH ≤ 4.5m: 4N12 BARS WITH R6-300 SPIRAL OR CLOSED TIES.
- 4.5m < PIER DEPTH ≤ 6.0m: 4N16 BARS WITH R10-300 SPIRAL.