

CONSTRUCTION NOTES

- ALL WORKS SHALL BE IN ACCORDANCE WITH, BUT NOT LIMITED TO, WATER SUPPLY CODE OF AUSTRALIA - WSA 03-2002-2.2 (SYDNEY WATER EDITION), PRESSURE SEWER SOLUTIONS Pty Ltd MASTERPLAN DRAWINGS & PITT TOWN WATER (P.T.W.) REQUIREMENTS.
- ALL EQUIPMENT, MATERIALS & ACCESSORIES USED IN THIS CONTRACT SHALL BE NEW, SHALL CONFORM WITH THE APPROPRIATE CURRENT AUSTRALIAN STANDARDS & SHALL COMPLY WITH P.T.W. REQUIREMENTS.
- ALL SERVICES SHOWN ARE INDICATIVE ONLY. A CURRENT SERVICES SEARCH & SITE CHECK OF ALL EXISTING SERVICES WILL BE REQUIRED PRIOR TO COMMENCEMENT OF ANY WORKS. THE CONTRACTOR IS TO DETERMINE LEVELS & LOCATIONS EXISTING SERVICES IN THE VICINITY OF THE CONSTRUCTION SITE AND ANY CONSTRUCTED STRUCTURES FOR PROPOSED SERVICES, SUCH AS DUCTING FOR WATER OR ELECTRICITY WITHIN THE SUBDIVISION. THE CONTRACTOR MUST ENSURE ALL SERVICES ARE LOCATED BY THE RELEVANT AUTHORITY PRIOR TO COMMENCEMENT OF WORKS.
- ALL RECYCLED WATER MAINS SHALL BE LILAC m.P.V.C. (PN16).
- MAIN TO BE LAID GENERALLY 2.4m P.L. EXCEPT WHERE OTHERWISE SHOWN. MINIMUM PIPE COVER SHALL BE 600mm IN FOOTPATHS & 1000mm FOR ROAD CROSSINGS. MAXIMUM PIPE COVER SHALL BE 1500mm UNLESS SPECIFIED ON THE DESIGN PLANS OR APPROVAL IS OBTAINED FROM THE P.T.W. REPRESENTATIVE.
- MAINS CROSSING UNDER DRIVEWAYS (SEALED, PAVED OR DECORATIVE) SHALL BE CONDUCTED BY UNDER BORING ONLY.
- MAINS WITHIN 2m OF ELECTRICITY OR POWER POLES SHALL BE CONDUCTED BY BORING TECHNOLOGY (UNLESS AGREED TO BY P.T.W. REPRESENTATIVE).
- ALL MAINS LAID IN (TRAFFICABLE) CARRIAGEWAYS SHALL BACKFILLED WITH 20:1 STABILISED SAND CEMENT TO SUBGRADE LEVEL.
- MARKER TAPE & TRACING WIRE SHALL BE INSTALLED TO P.T.W. REQUIREMENTS.
- DURING CONSTRUCTION, ALL OPEN ENDS OF PIPE SHALL BE CAPPED OFF TO PREVENT ENTRY OF FOREIGN MATTER.
- ALL VALVES SHALL BE RESTRAINED IN ACCORDANCE WITH WAT-1207.
- THE CONTRACTOR SHALL PROVIDE P.T.W. WITH MINIMUM OF 7 DAYS NOTICE OF INTENT TO CONNECT NEW MAINS TO EXISTING INFRASTRUCTURE.
- UPON COMPLETION OF WORKS, ALL SURFACES MUST BE RESTORED AS CLOSE AS POSSIBLE, TO THE CONDITION THAT EXISTED PRIOR TO COMMENCEMENT OF WORK.
- PERMISSION OF ENTRY MUST BE OBTAINED BY THE CONTRACTOR FROM THE OWNER/OCCUPIER PRIOR TO COMMENCEMENT OF WORK IN PRIVATE PROPERTY.
- THE CONTRACTOR SHALL PROVIDE P.T.W. WITH WITH M.G.A. COORDINATES OF THE WORK-AS-CONSTRUCTED SURVEY. BURIED FITTINGS ARE NOT TO BE BACKFILLED UNTIL W.A.C. DETAILS HAVE BEEN OBTAINED & APPROVAL FOR BACKFILLING GIVEN BY THE P.T.W. REPRESENTATIVE.
- THE MINIMUM NUMBER OF COMPACTION TESTS REQUIRED TO SATISFY THE WATER SUPPLY CODE OF AUSTRALIA ARE:
TRAFFICABLE: PIPE EMBEDMENT ZONE: NIL TRENCH FILL ZONE: NIL ** REFER NOTE 8 **
NON-TRAFFICABLE: PIPE EMBEDMENT ZONE: 4 TESTS TRENCH FILL ZONE: 4 TESTS
- ALL MAINS SHALL BE FLUSHED WITH WATER TO REMOVE ANY DEBRIS PRIOR TO COMMISSIONING.
- ALL PROPERTY (MAIN TO METER) SERVICES MUST BE CONSTRUCTED TO SYDNEY WATER'S INSTALLATION REQUIREMENTS BY A LICENSED PLUMBER. THE WORKS MUST BE INSTALLED IN ACCORDANCE WITH THE CURRENT SYDNEY WATER PROPERTY (MAIN TO METER) SERVICE INSTALLATIONS TECHNICAL REQUIREMENTS, NSW CODE OF PRACTICE FOR PLUMBING & DRAINAGE AND AS/NZS3500.
- SURFACE IDENTIFICATION MARKERS ARE TO BE PROVIDED TO P.T.W. REQUIREMENTS.

PIPE SCHEDULE

SIZE	TYPE	CLASS	LENGTH
DN100	m.P.V.C.	PN16	410

RAR (Infrastructure) Pty Ltd
On Behalf Of
Pitt Town Water
Date: 17 / 02 / 2014
FOR CONSTRUCTION

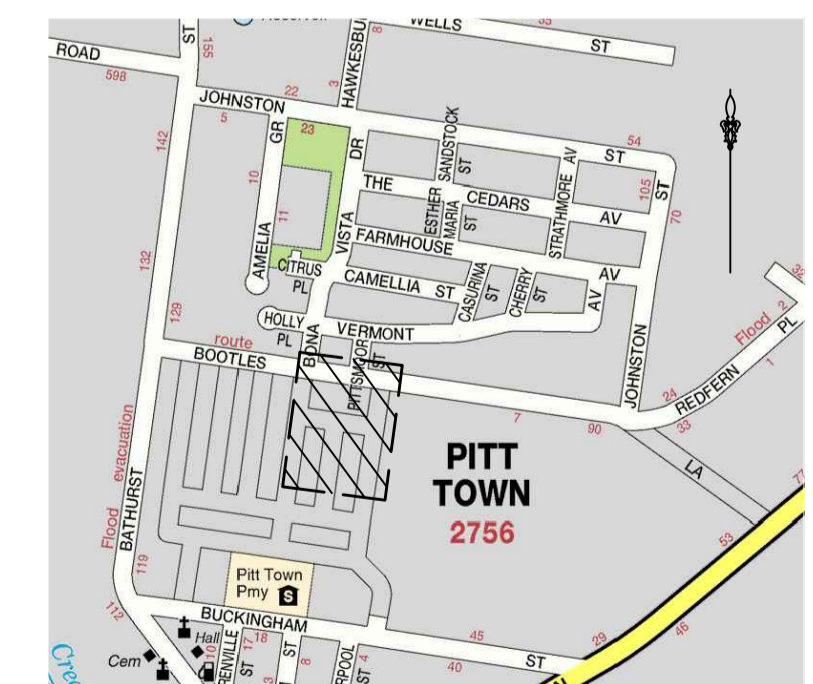

LOCALITY DIAGRAM
(NOT TO SCALE)

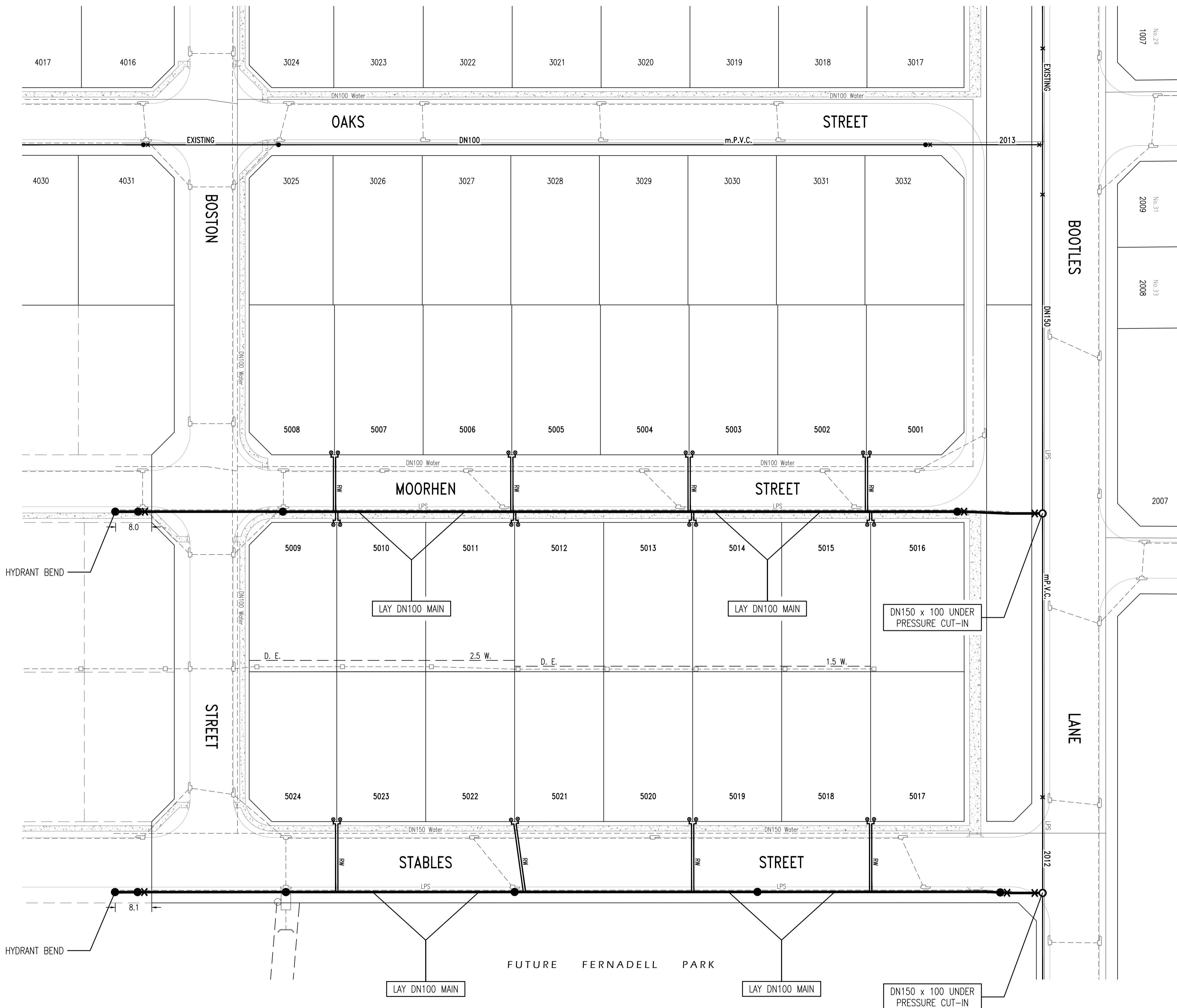

SERVICE	DATE	REF.

ROSE ATKINS RIMMER (Infrastructure) Pty. Ltd.
RAR
WATER RELATED INFRASTRUCTURE DESIGN AND MANAGEMENT
142 SUNNYHOLT ROAD, BLACKTOWN
P.O. BOX 6745, BLACKTOWN N.S.W. 2148
PH: (02) 9853 0200 FAX: (02) 9671 7399



PLAN OF PROPOSED RECYCLED WATER INFRASTRUCTURE
FERNADELL SUBDIVISION - STAGE 5
MOORHEN STREET & STABLES STREET, PITT TOWN
L.G.A. HAWKESBURY

PITT TOWN WATER REF: STAGE Pt.18P & Pt.19P				SHEET 1 OF 1	VERSION: 02
DRAWN: D.SHEATHER	SCALE: 1:500	DATE: 67 H12	DATE: 11/2/2014		
CHECKED: R.CHIVAS	DESIGNED: S.RIMMER	APPROVED:			10/20978/F5