

CONSTRUCTION NOTES

- ALL WORKS ARE IN ACCORDANCE WITH, BUT NOT LIMITED TO, WATER SUPPLY CODE OF AUSTRALIA - WSA 03-2002-2.2 (SYDNEY WATER EDITION), PRESSURE SEWER SOLUTIONS Pty Ltd MASTERPLAN DRAWINGS & PITT TOWN WATER (P.T.W.) REQUIREMENTS.
- ALL EQUIPMENT, MATERIALS & ACCESSORIES USED IN THIS CONTRACT WAS NEW, CONFORMED WITH THE APPROPRIATE CURRENT AUSTRALIAN STANDARDS & DID COMPLY WITH P.T.W. REQUIREMENTS.
- ALL SERVICES SHOWN WERE INDICATIVE ONLY. A CURRENT SERVICES SEARCH & SITE CHECK OF ALL EXISTING SERVICES WAS REQUIRED PRIOR TO COMMENCEMENT OF ANY WORKS. THE CONSTRUCTOR DETERMINED LEVELS & LOCATIONS EXISTING SERVICES IN THE VICINITY OF THE CONSTRUCTION SITE AND ANY CONSTRUCTED STRUCTURES FOR PROPOSED SERVICES, SUCH AS DUCTING FOR WATER OR ELECTRICITY WITHIN THE SUBDIVISION. THE CONTRACTOR ENSURED ALL SERVICES WERE LOCATED BY THE RELEVANT AUTHORITY PRIOR TO COMMENCEMENT OF WORKS.
- ALL RECYCLED WATER MAINS ARE LILAC m.P.V.C. (PN16).
- MAIN LAID GENERALLY 2.4m P.L. EXCEPT WHERE OTHERWISE SHOWN. MINIMUM PIPE COVER IS 600mm IN FOOTPATHS & 1000mm FOR ROAD CROSSINGS. MAXIMUM PIPE COVER IS 1500mm UNLESS SPECIFIED ON THE DESIGN PLANS OR APPROVAL HAD BEEN OBTAINED FROM THE P.T.W. REPRESENTATIVE.
- MAINS CROSSING UNDER DRIVEWAYS (SEALED, PAVED OR DECORATIVE) WERE CONDUCTED BY UNDER BORING ONLY.
- MAINS WITHIN 2m OF ELECTRICITY OR POWER POLES WERE CONDUCTED BY BORING TECHNOLOGY (UNLESS AGREED TO BY P.T.W. REPRESENTATIVE).
- ALL MAINS LAID IN (TRAFFICABLE) CARRIAGEWAYS WERE FILLED WITH 20:1 STABILISED SAND CEMENT TO SUBGRADE LEVEL.
- MARKER TAPE & TRACING WIRE WAS INSTALLED TO P.T.W. REQUIREMENTS.
- DURING CONSTRUCTION, ALL OPEN ENDS OF PIPE WERE CAPPED OFF TO PREVENT ENTRY OF FOREIGN MATTER.
- ALL VALVES WERE RESTRAINED IN ACCORDANCE WITH WAT-1207.
- THE CONSTRUCTOR PROVIDED P.T.W. WITH MINIMUM OF 7 DAYS NOTICE OF INTENT TO CONNECT NEW MAINS TO EXISTING INFRASTRUCTURE.
- UPON COMPLETION OF WORKS, ALL SURFACES WERE RESTORED AS CLOSE AS POSSIBLE, TO THE CONDITION THAT EXISTED PRIOR TO COMMENCEMENT OF WORK.
- PERMISSION OF ENTRY WAS OBTAINED BY THE CONTRACTOR FROM THE OWNER/OCCUPIER PRIOR TO COMMENCEMENT OF WORK IN PRIVATE PROPERTY.
- THE CONTRACTOR PROVIDED P.T.W. WITH M.G.A. COORDINATES OF THE WORK-AS-CONSTRUCTED SURVEY. BURIED FITTINGS WERE NOT BACKFILLED UNTIL W.A.C. DETAILS HAD BEEN OBTAINED & APPROVAL FOR BACKFILLING GIVEN BY THE P.T.W. REPRESENTATIVE.
- THE MINIMUM NUMBER OF COMPACTION TESTS REQUIRED TO SATISFY THE WATER SUPPLY CODE OF AUSTRALIA ARE:

TRAFFICABLE:	PIPE EMBEDMENT ZONE: NIL	TRENCH FILL ZONE: NIL	** REFER NOTE 8 **
NON-TRAFFICABLE:	PIPE EMBEDMENT ZONE: 6 TESTS	TRENCH FILL ZONE: 6 TESTS	
- ALL MAINS WERE FLUSHED WITH WATER TO REMOVE ANY DEBRIS PRIOR TO COMMISSIONING.
- ALL PROPERTY (MAIN TO METER) SERVICES WERE CONSTRUCTED TO SYDNEY WATER'S INSTALLATION REQUIREMENTS BY A LICENSED PLUMBER. THE WORKS WERE INSTALLED IN ACCORDANCE WITH THE CURRENT SYDNEY WATER PROPERTY (MAIN TO METER) SERVICE INSTALLATIONS TECHNICAL REQUIREMENTS, NSW CODE OF PRACTICE FOR PLUMBING & DRAINAGE AND AS/NZS3500.
- SURFACE IDENTIFICATION MARKERS WERE PROVIDED TO P.T.W. REQUIREMENTS.

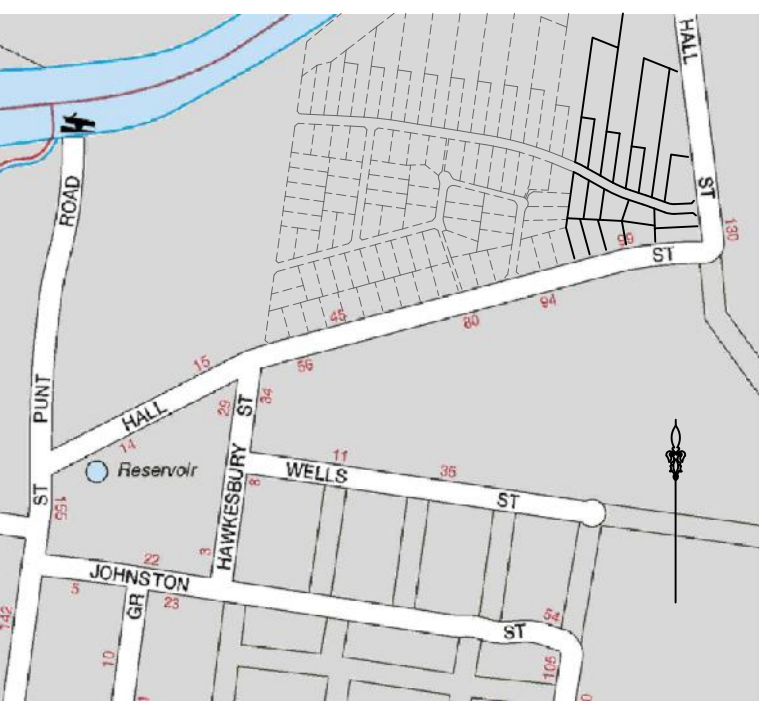

PIPE SCHEDULE

SIZE	TYPE	CLASS	LENGTH
DN100	m.P.V.C.	PN16	714.6

WORK-AS-CONSTRUCTED CERTIFICATION

DEVELOPER: JOHNSON PROPERTY GROUP Pty. Ltd.
 PROJECT SUPERVISOR: ROSE ATKINS RIMMER (INFRASTRUCTURE) Pty. Ltd.
 CONSTRUCTOR: BOOMDELL Pty. Ltd.
 COMPLETED: 22/6/2015 W.A.C. PREPARED: 15/9/2016

DESIGNER: ROSE ATKINS RIMMER (INFRASTRUCTURE) Pty. Ltd.

I CERTIFY THAT THE WORKS HAVE BEEN CONSTRUCTED IN ACCORDANCE WITH THE WORK AS CONSTRUCTED DRAWINGS.

SERVICE	DATE	REF.

SCALE BAR: 0 10 20 30 40 50 METRES

ROSE ATKINS RIMMER (Infrastructure) Pty. Ltd.
 WATER RELATED INFRASTRUCTURE DESIGN AND MANAGEMENT
 142 SUNNYHOLT ROAD, BLACKTOWN
 P.O. BOX 6745, BLACKTOWN N.S.W. 2148
 PH: (02) 9853 0200 FAX: (02) 9671 7399



PLAN OF PROPOSED RECYCLED WATER INFRASTRUCTURE
 CLEARY SUBDIVISION - STAGE 4
 HALL STREET & CLEARY DRIVE, PITT TOWN
 L.G.A. HAWKESBURY

PITT TOWN WATER REF: STAGE 4P				SHEET 1 OF 2	VERSION: WAC
DRAWN: D.SHEATHER	SCALE: 1:500	DATE: 67 L7-M7	DATE: 15/9/2016	10/20978/C4	
CHECKED: S.RIMMER	REVIEWED: D.SAWKINS	APPROVED:	DATE:		

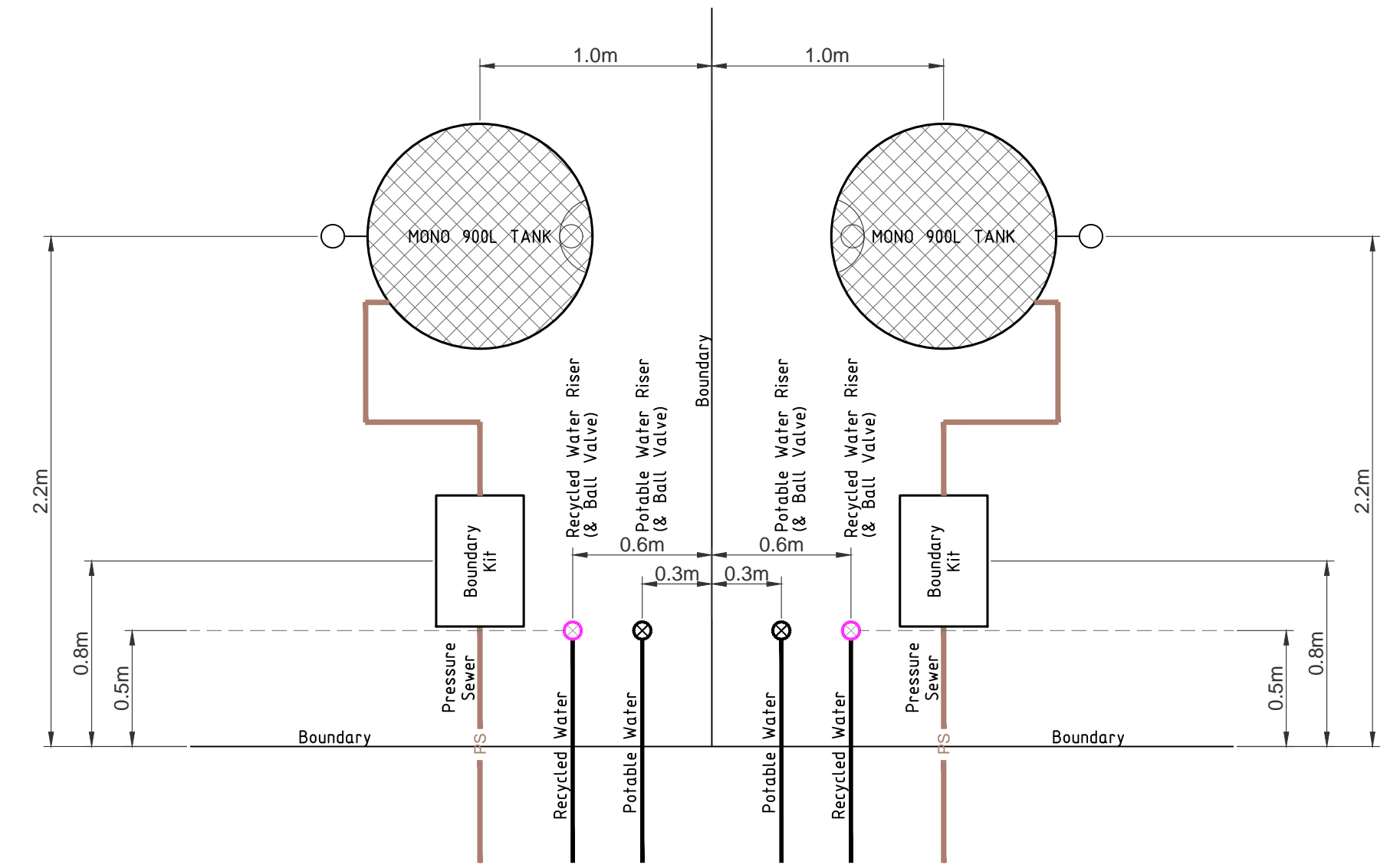
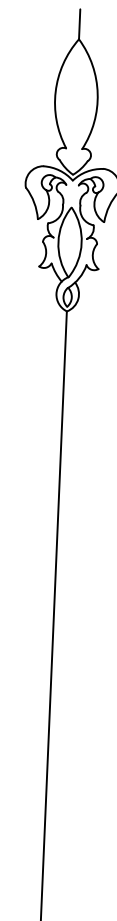
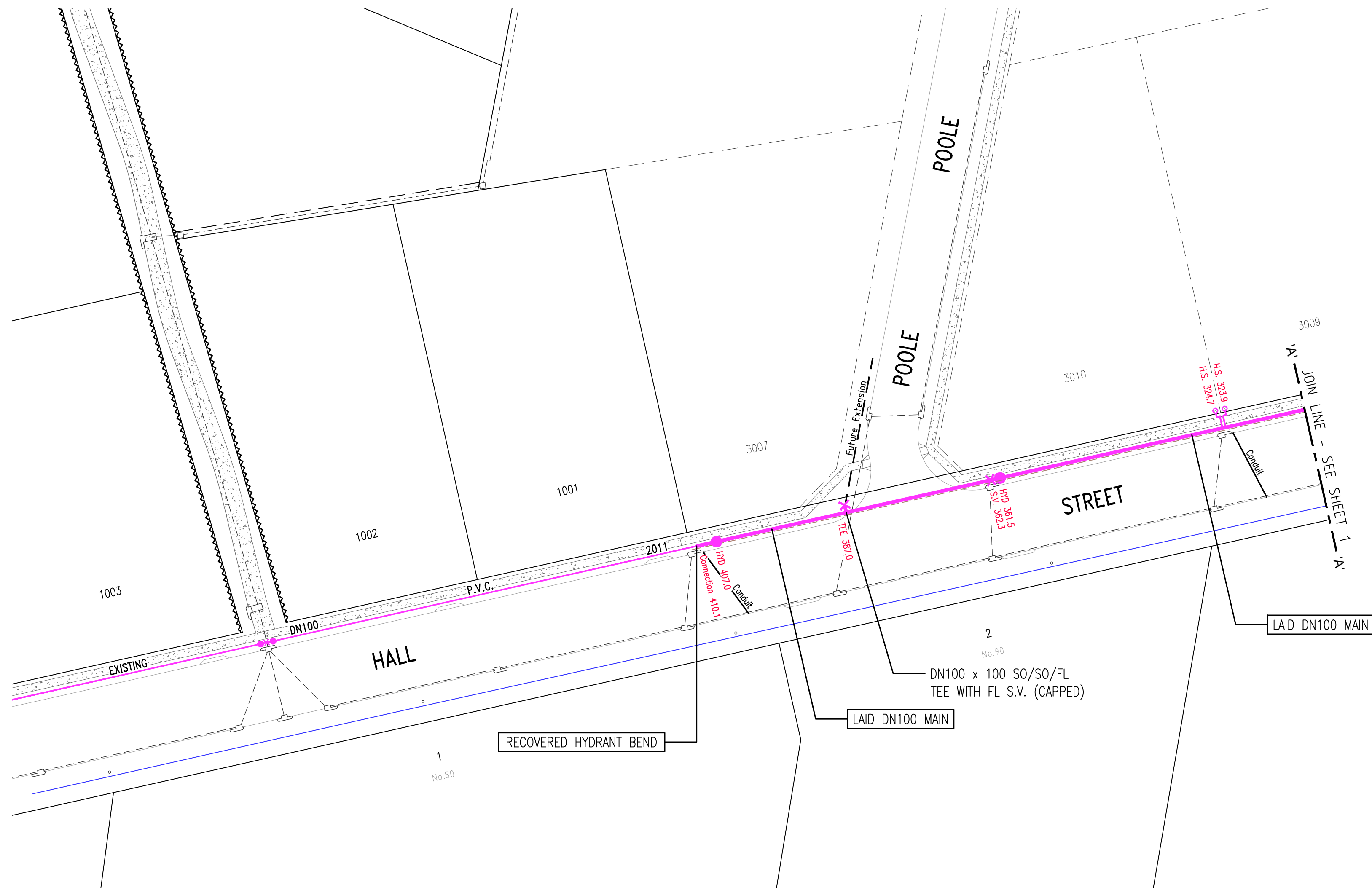

ROAD RESERVE
WATER SERVICE CONFIGURATION (TYPICAL)
(NOT TO SCALE)

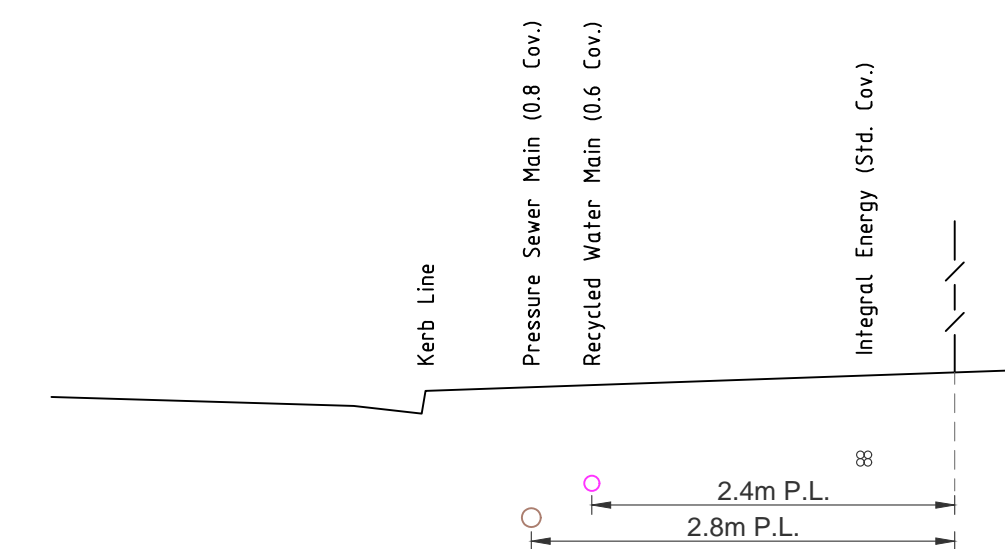

TYPICAL ALLOCATION DIAGRAM
(NOT TO SCALE)