

LOCALITY DIAGRAM
(NOT TO SCALE)

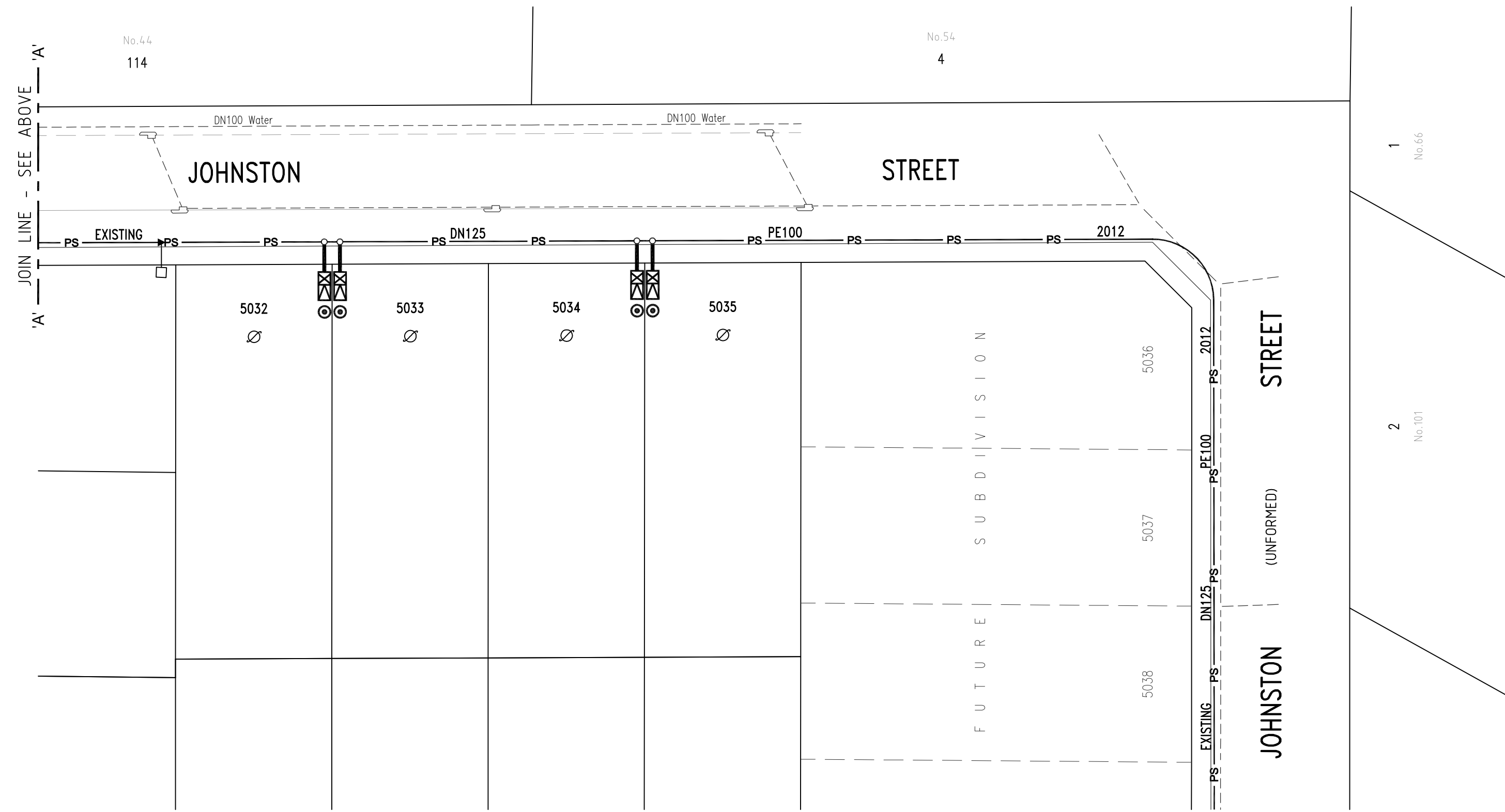

PIPE SCHEDULE

SIZE	TYPE	CLASS	LENGTH
DN40	PE100	PN16	106

RAR (Infrastructure) Pty Ltd
On Behalf Of
Pitt Town Water
Date: 19 / 03 / 2014
FOR CONSTRUCTION

CONSTRUCTION NOTES

- ALL WORKS SHALL BE IN ACCORDANCE WITH, BUT NOT LIMITED TO, PRESSURE SEWERAGE CODE OF AUSTRALIA - WSA 07-2007, POLYETHYLENE PIPELINE CODE WSA 01-2004, PRESSURE SEWER SOLUTIONS Pty Ltd MASTERPLAN DRAWINGS & PITT TOWN WATER (P.T.W.) REQUIREMENTS.
- ALL EQUIPMENT, MATERIALS & ACCESSORIES USED IN THIS CONTRACT SHALL BE NEW, SHALL CONFORM WITH THE APPROPRIATE CURRENT AUSTRALIAN STANDARDS & SHALL COMPLY WITH P.T.W. REQUIREMENTS.
- ALL SERVICES SHOWN ARE INDICATIVE ONLY. A CURRENT SERVICES SEARCH & SITE CHECK OF ALL EXISTING SERVICES WILL BE REQUIRED PRIOR TO COMMENCEMENT OF ANY WORKS. THE CONSTRUCTOR IS TO DETERMINE LEVELS & LOCATIONS EXISTING SERVICES IN THE VICINITY OF THE CONSTRUCTION SITE AND ANY CONSTRUCTED STRUCTURES FOR PROPOSED SERVICES, SUCH AS DUCTING FOR WATER OR ELECTRICITY WITHIN THE SUBDIVISION. THE CONTRACTOR MUST ENSURE ALL SERVICES ARE LOCATED BY THE RELEVANT AUTHORITY PRIOR TO COMMENCEMENT OF WORKS.
- PRESSURE SEWER MAINS SHALL BE BLACK POLYETHYLENE (PE100 PN16) WITH A CREAM STRIPE AS PER WSA 02-2007.
- ALL POLYETHYLENE MAINS SHALL BE JOINED ELECTROFUSION TECHNIQUES IN ACCORDANCE WITH THE MANUFACTURERS REQUIREMENTS.
- ALL MAINS LAID IN (TRAFFICABLE) CARRIAGEWAYS SHALL BACKFILLED WITH 20:1 STABILISED SAND CEMENT TO SUBGRADE LEVEL.
- ALL HOUSE SERVICE LATERALS SHALL BE DN40 (PE100 PN16).
- ALL MAINS MUST BE TESTED (AS DIRECTED BY THE P.T.W. REPRESENTATIVE) TO MEET CERTIFYING AUTHORITY STANDARDS.
- THE CONSTRUCTOR SHALL PROVIDE P.T.W. WITH MINIMUM OF 7 DAYS NOTICE OF INTENT TO CONNECT NEW MAINS TO EXISTING INFRASTRUCTURE.
- Ø DENOTES DN40 LATERAL TO BE INSTALLED ON EXISTING DN90 MAIN.
- UPON COMPLETION OF WORKS, ALL SURFACES MUST BE RESTORED AS CLOSE AS POSSIBLE, TO THE CONDITION THAT EXISTED PRIOR TO COMMENCEMENT OF WORK.
- BURIED FITTINGS ARE NOT TO BE BACKFILLED UNTIL W.A.C. DETAILS HAVE BEEN OBTAINED & APPROVAL FOR BACKFILLING GIVEN BY THE P.T.W. REPRESENTATIVE.
- THE MINIMUM NUMBER OF COMPACTION TESTS REQUIRED TO SATISFY THE PRESSURE SEWER CODE OF AUSTRALIA (CLAUSE 21.3.4) ARE:
TRAFFICABLE:
PIPE EMBEDMENT ZONE: NIL TRENCH FILL ZONE: NIL
NON-TRAFFICABLE:
PIPE EMBEDMENT ZONE: NIL TRENCH FILL ZONE: NIL
- BOUNDARY KITS SHALL BE 316 STAINLESS STEEL BALL VALVE & SWING CHECK VALVE (CLASS 16), COMPLETE WITH OPEN BASE ACCESS BOX WITH LID. MONO 900L TANK (PSS-ECO180) SHALL BE INSTALLED WITH BOUNDARY KIT (REFER GENERAL ARRANGEMENT). PUMP TO BE INSTALLED BY OTHERS.

SERVICE	DATE	REF.

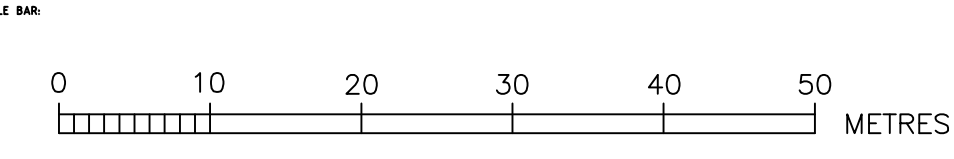

ROSE ATKINS RIMMER (Infrastructure) Pty. Ltd.
WATER RELATED INFRASTRUCTURE DESIGN AND MANAGEMENT
142 SUNNYHOLT ROAD, BLACKTOWN
P.O. BOX 6745, BLACKTOWN N.S.W. 2148
PH: (02) 9853 0200 FAX: (02) 9671 7399



PLAN OF PROPOSED LOW PRESSURE SEWER INFRASTRUCTURE
BONA VISTA SUBDIVISION - STAGE 5B
JOHNSTON STREET & STRATHMORE AVENUE, PITT TOWN
L.G.A. HAWKESBURY

PITT TOWN WATER REF: STAGE Pt.5P				SHEET 1 OF 3	VERSION 01
DRAWN	SCALE	DATUM	U.S.A. REFERENCE	JOB No.	10/20978/BV5b
D.SHEATHER	1:500	-	67 K10		
VERIFIED	REVIEWED	APPROVED	DATE	17/3/2014	
V.VIKSNE	S.RIMMER				

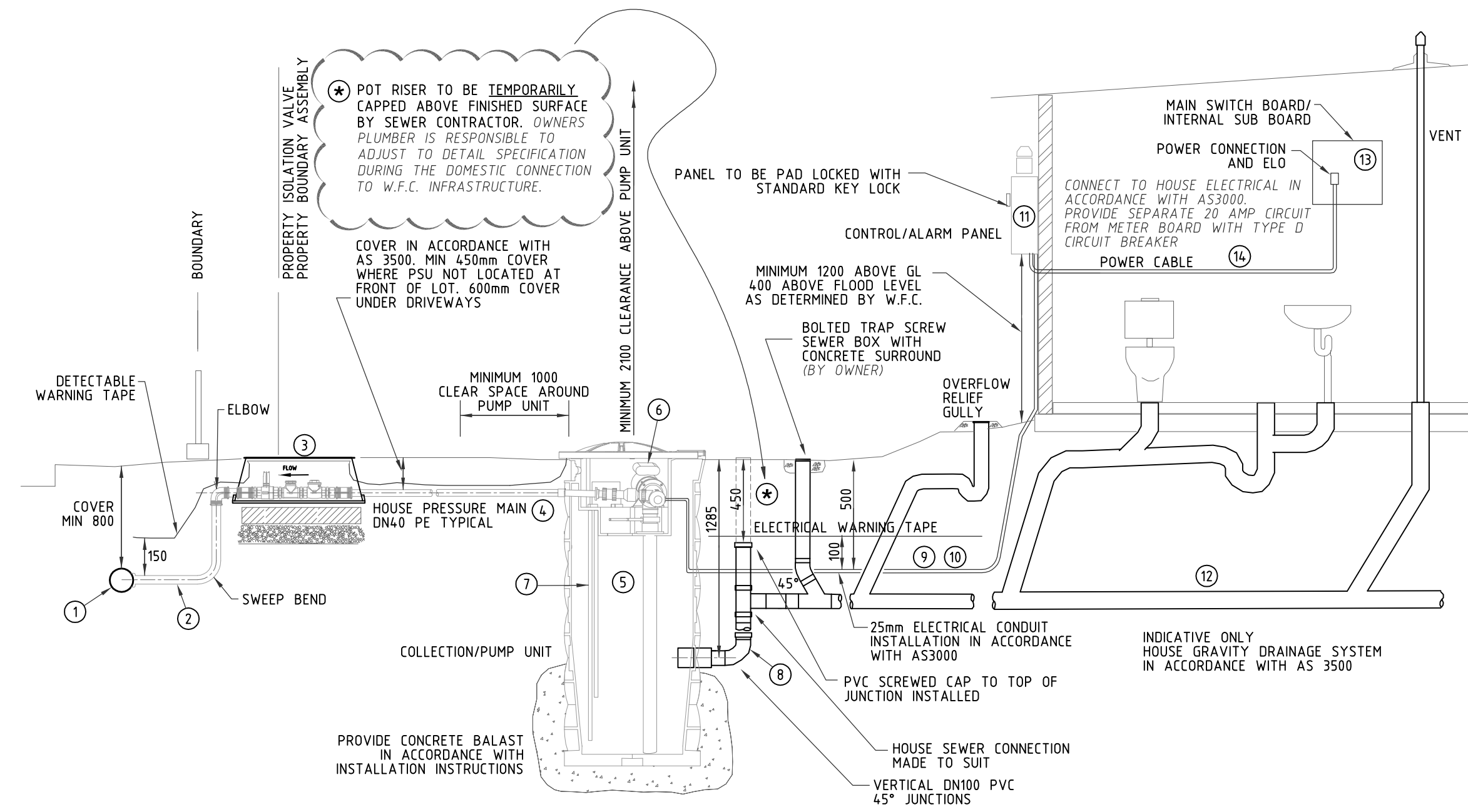

PUMP UNIT INSTALLATION - CROSS SECTION

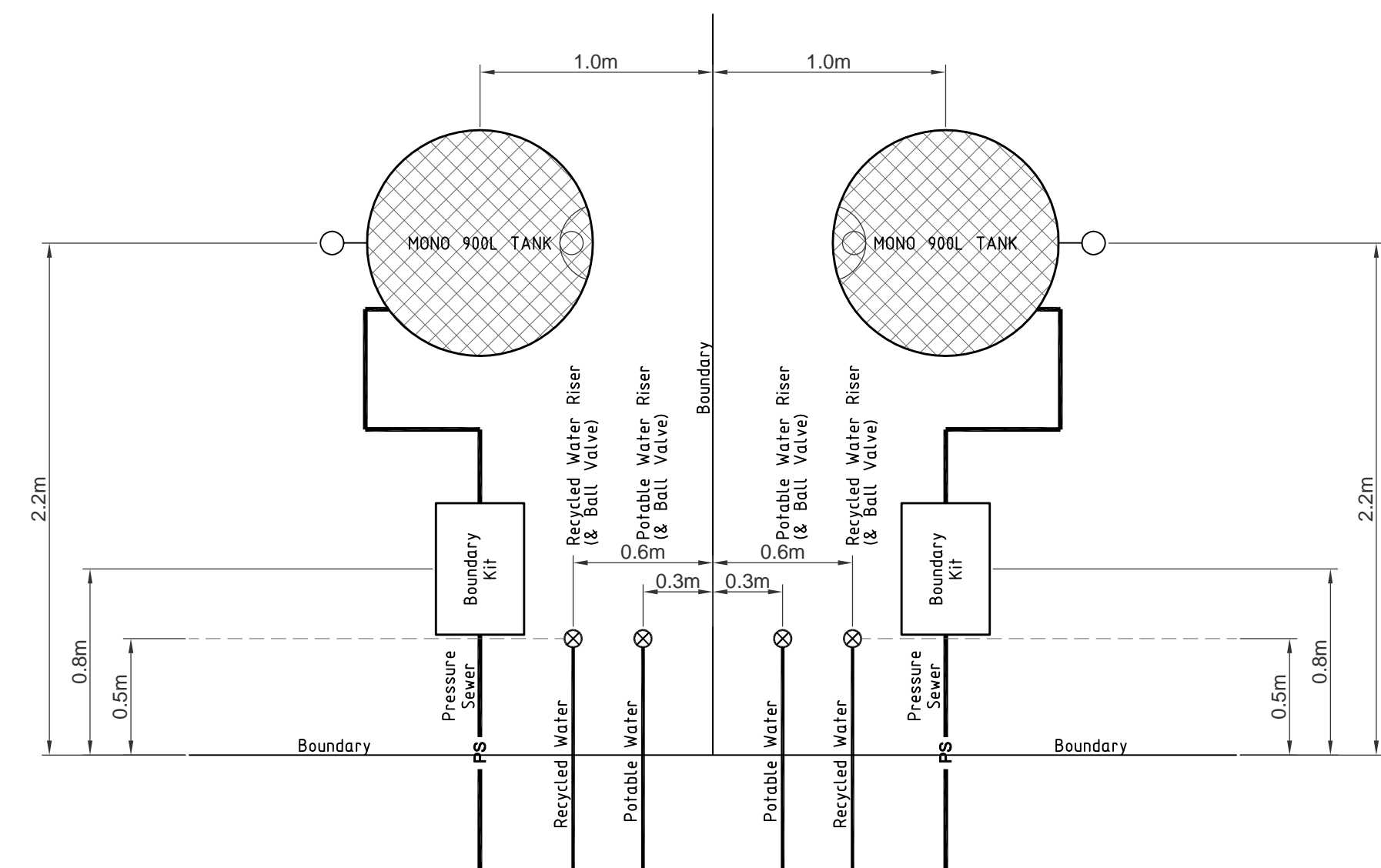

WATER SERVICE CONFIGURATION (TYPICAL)
(NOT TO SCALE)

